

Note there happens a small surplus quantity of land in this Survey. it is joined all Round with Company warrants and no dispute in Case therefore the owner pray's Acceptance of the Survey

Jn^o M^cClean

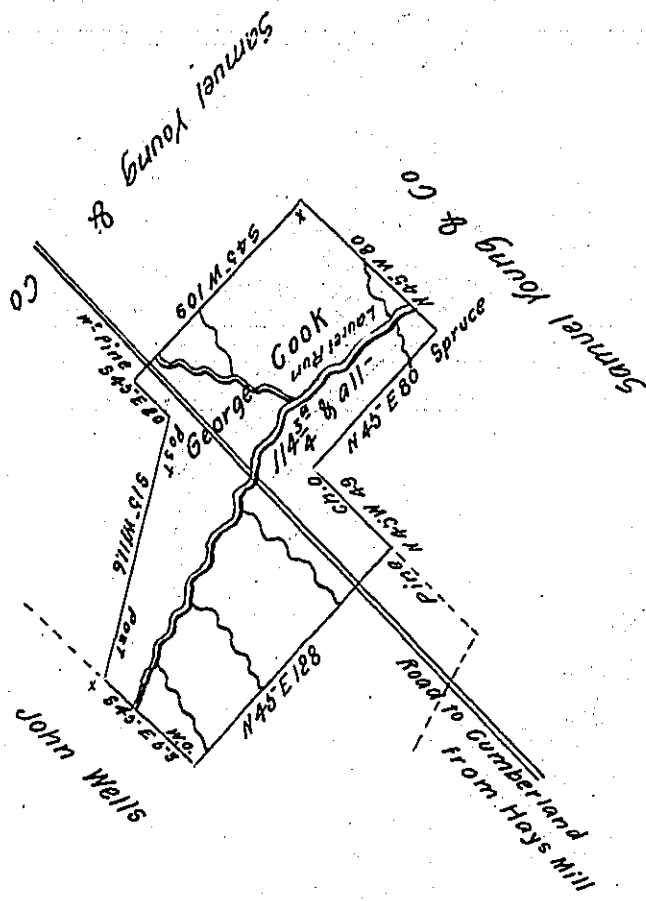

Situate on the Laurel Run including both sides of the Road leading from Simion Hays Mill to Cumberland (formerly in Londonderry Township Bedford) Now Southampton Township Somerset County and Surveyed the 11th day of March 1794 by Alexander M^cClean Esq^r late D. S. In pursuance of a Warrant dated the 13th day of August 1793 for 100^a

Certified the 11th day of October 1805

To Samuel Cochran Esquire

Pr John M^cClean Deputy

Surveyor General

IN TESTIMONY that the above is a copy of the original remaining on file in the Department of Internal Affairs of Pennsylvania, made conformably to an Act of Assembly approved the 16th day of February, 1833, I have hereunto set my Hand and caused the Seal of said Department to be affixed at Harrisburg, this twenty fourth day of March 1904.

Loac R. Brown
Secretary of Internal Affairs.